



the model 3

cedar+stone
NORDIC SAUNA



our lives are stressful,
sauna changes us.

We are reconnecting people to the centuries old rituals of thermic bathing. We invite you to a more present life removed from screens and connected to nature, your body, and your closest people.

your new daily ritual

FEATURES

- Up to 3 person capacity sauna
- Modern Nordic design
- Dramatic full length windows
- Environmentally conscious materials
- Integrated LED lighting

YOUR CHOICE

- Wi-fi Enabled heater or wood-fired stove

STARTING AT \$49,900





premium quality materials, with the planet in mind

Carbon storing cross laminated timber construction // Domestically sourced thermally modified cladding choices from Arbor Wood Co. //
Sustainably sourced western red cedar interiors // Handcrafted in the USA // Delivered throughout North America by our team to you



SHOWN IN
Arborwood Burned + Brushed Pine Black Oil Finish // Exterior cladding
Loll Designs Cabrio chairs // Modern Outdoor Furniture

the highest quality heat, in
our most efficient size yet.

SEATS

- 3 people comfortably

WEIGHT

- ~4,000 lbs

HOT ROOM VOLUME

- 236 cubic feet

DIMENSIONS

- Overall footprint - 7' 6" W x 9' L x 9' 4" H
- Hot room finished internal dimension - 5' 2" W X 5' 8" L
- Entryway - 7' 2" W x 2' 6" L
- Bench length - 5' 8" L





model 3 dimensions

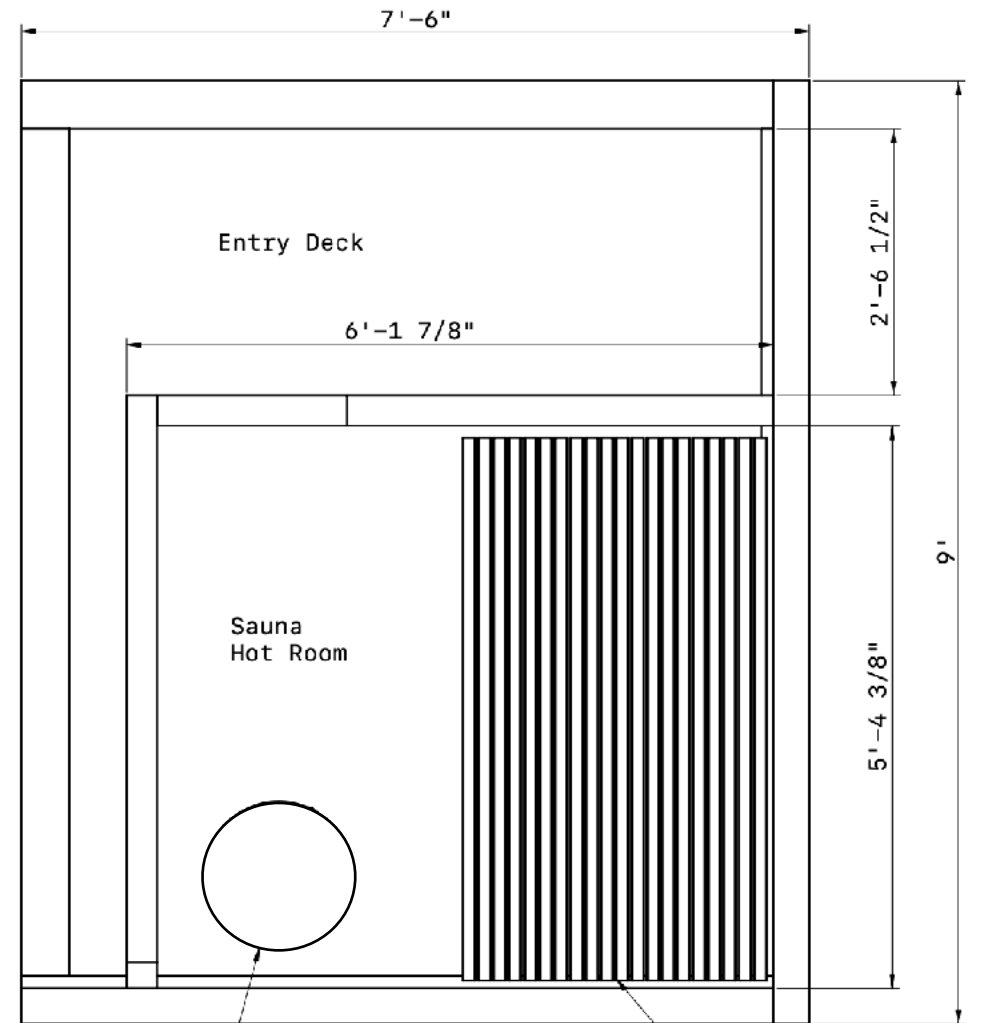

Sauna Heater:
Wifi-enabled electric or
Wood-Fired

Two Tier Cedar Benches
(19" deep)

A photograph of a wooden sauna interior. The walls and floor are made of light-colored wood. A wooden bench is visible in the background. A large, dark silhouette of a person is sitting on the bench, facing away from the camera. The lighting is warm and low, creating a cozy atmosphere.

customizable for your
curated aesthetic

MODE
The high

model 3 options

HEATING SOURCE

ELECTRIC HEATER (STANDARD)

Options for heater model:

- HUUM Hive Mini 9kW (shown right)
- IKI Wall 9kW

Both stove options come standard with a Wi-Fi enabled controller to remotely warm your sauna.

WOODBURNING STOVE (UPGRADE)*

Options for stove model:

- HUUM Hive Wood 13kW
- Mini IKI Plus

* Wood-burning stoves include powder-coated steel hearth and heat shields in the hot room for added safety and minimal distances to combustibles.





choose your ritual of heat

HEATING SOURCE OPTIONS:



HUUM HIVE MINI



IKI WALL 6KW



HUUM WOOD
13KW



IKI MINI PLUS

exterior finishes

EXTERIOR CLADDING - ARBORWOOD CO. THERMALLY MODIFIED WOOD



PINE (STANDARD)

Contrast grain // Softwood

Available in:

Black Semi-Solid Stain OR Chestnut Oil Stain



ASH (UPGRADE)

Tight grain // Hardwood

Available in:

Black Semi-Solid Stain OR Chestnut Oil Stain



CHARRED PINE (UPGRADE)

Burned brushed grain // Japanese inspired

Available in:

Black Oil Finish

LEARN MORE ABOUT FINISHES:

[Watch on YouTube](#)

*For more options and details on Arbor Wood Co. Thermally Modified Products visit:
arborwoodco.com/siding*

exterior finishes (cont.)

WINDOW OPTIONS

- Window Wall 78 ½” H x 50” W (standard)
- Transom Privacy Window 18” H x 50”W (optional add on)
- Options for Smoked, Mirrored, or Frosted Glass

STANDARD ACCENTS

- Cedar decking
- Cedar rain screen accent wall
- White oak window and door casings (Stained black)
- Exterior Sconce
- Towel Hooks
- Outdoor Convenience Outlet
- Digital sauna heater control (Electrically heated saunas)
- Wall Mounted Thermometer (Wood-fired saunas)

ADD ONS

- Hardwood decking in Arborwood Ash
- Wrap around opera steps (show right)
- Outdoor shower



interior finishes

HOT ROOM

- 2 levels of benches for multiple heat zones
- Cedar screen wall paneling // Cedar window & door trims
- Cedar paneling entry wall — Black sauna wax stain
- Integrated warm under bench LED lighting
- Passive ventilation for fresh air exchange
- Benches are cedar with replaceable slat panels
- Screened draining cedar floor with replaceable deck boards

OPTIONS

- Black waxed or raw cedar paneling on entry and window wall (Upgrade)



our process

1. RESERVATION DEPOSIT

With a deposit of \$15,000, we will save your spot in our production queue making sure your sauna is ready when you need it.

2. SIGN CONTRACT

Let's get all the details on paper. Our team will work with you on all aspects of your project. We will consult on design choices, final finishes, site access, and utility preparation.

3. SIT BACK & RELAX

As we begin ordering and construction, our team will keep you updated as your sauna is being built. Most projects move from deposit to completion in 4-6 months. Our team will work with you on a target date for installation to ensure any needed site prep is completed.

4. SHIPPING & INSTALLATION

When your sauna is complete we will coordinate shipping with our carriers and any needed local contractors. Installation commonly lasts 1-3 days. Then you can start enjoying your sauna practice.

Contact our team to get started.



site prep & installation

PRIOR TO INSTALLATION:

For release of shipment of sauna our team will confirm all required site prep is completed.

Site prep includes:

- Leveling of ground elevation slope near pad
- Installation of four 18” in diameter concrete footings
- Installation of crushed rock pad for appropriate drainage
- Electrical run to sauna site (240v 60 amp Service)
- Water lines run to sauna site (if outdoor shower is ordered)

Our project manager will provide you with your fully detailed site plan to clarify any communication with on-site contractors and/or permitting.

INSTALLATION:

Cedar and Stone delivery and complete installation includes:

- Delivery to site from Duluth, MN (shipping quoted separately)
- On-site final leveling onto concrete footings
- Final Detailing, cleaning, and handoff for client
- Full white glove service with all details managed by our team



handcrafted in the usa

Delivered throughout North America by our team to you





experience in person

NORDLYS LODGING CO. // FREDRIC, WI
BOOK YOUR SAUNA & STAY



FOUR SEASONS

MINNEAPOLIS, MN //

BOOK YOUR SAUNA & STAY





DULUTH, MN // DESIGN STUDIO
TOUR HQ & BOOK A SAUNA EXPERIENCE



our commitment to you

For me, the sauna is beautiful and sacred.

Growing up, the sauna was the space our family gathered. Second, only to the dinner table. This practice has shaped my life.

Now it's an honor to invite more people to lives removed from screens and impacted with sauna.

The ritual of sauna has been impacting lives for thousands of years. Over the next decade we are committed to host 1 million people in our saunas to build more resilient lives.

If you are considering one of our saunas for your home, or a commercial setting, we have endeavored to create saunas that are committed to beautiful design, long lasting quality, and sustainable materials.

May you invite others into the cultural gift of sauna that continues to impact lives so deeply.

Stay warm,

Justin Juntunen

Founder/CEO, Cedar & Stone Nordic Sauna



cedar+stone
NORDIC SAUNA

1325 N 59th Ave W Duluth, MN 55807 | www.cedarandstonesauna.com | E: sales@cedarandstonesauna.com | P: 218.451.2183